

APPENDIX 1 : Théâtre Lycée Français de San Francisco - Techniques

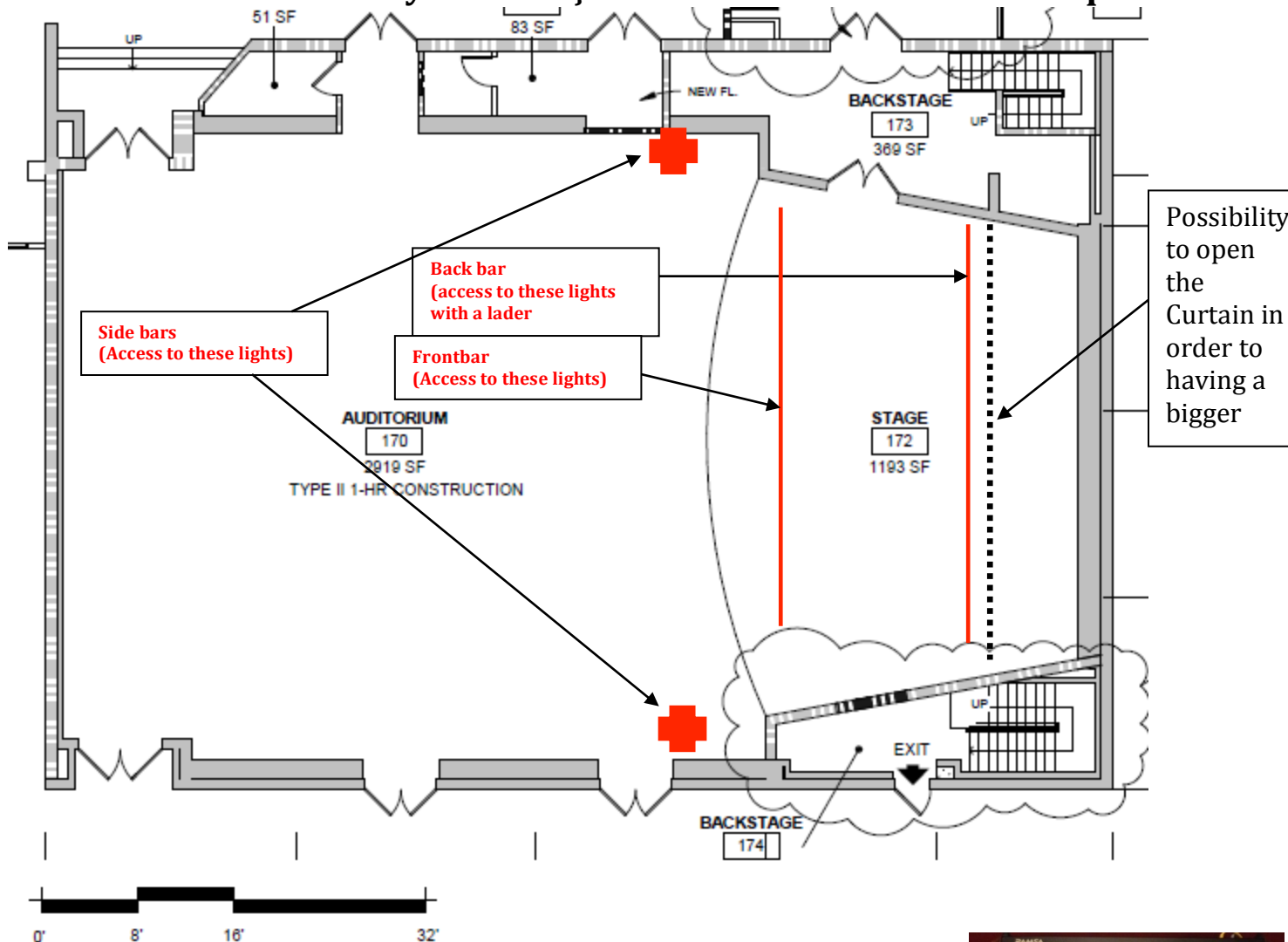

List Of Equipment for TLF

1. Ramsa 12 channel Audio Mixer #WR8112
2. Crown 2 channel PS-400 Power Amp
3. No Onstage Monitors
4. Digital Projector
5. Micro Phones 2 SM-58 (PGX -2 Wireless)
2 each SM-58 2 each SM-58 (Onstage Overhead)
6. DVD Player
7. Lap Top available if needed
8. 16 x 12 Movie screen fixed in place on rear wall
9. Light board

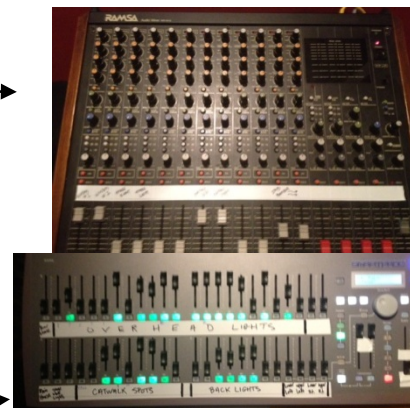

10. 2 each JBL eon 15p-1 Powered speakers
11. Lighting Approximatley 39 spots with 10 preset switches and ability to customize same with Light board.

12. A piano

LIGHTS

Instrument Count:

Source-4 26 degrees - 1

Source-4 50 degrees - 5

Extra 50 degree barrel - 1

Source-4 Parnels - 18

Source-4 Jr 26 degrees - 2

Source-4 Jr 36 degrees - 8

Source-4 Jr 50 degrees - 8

All instruments are Stage-Pin (as is the theater). The space contains no extra jumper cable.

The space has a short (6 ft) ladder, and an extension ladder. There is no ladder capable of reaching the fly pipe, so only a "bounce" focus is currently possible. The extension ladder can reach the instruments on the stationary pipe, but just barely, and it is somewhat precarious. This makes those instruments very difficult to adjust.

There is a front catwalk as well with easy access.